

LITHIUM BATTERY

BR - C

(MODEL NO. BR-CSP)

SPECIFICATION



Revised Jul. 1. 1997
Oct. 21. 1996

Stipulated	Checked	Described
<i>H. Sato</i>	<i>T. Kanda</i>	<i>M. Eya</i>

MATSUSHITA BATTERY INDUSTRIAL CO., LTD.
LITHIUM & MICRO BATTERY DIVISION

1. Model Number : BR-CSP (Bare cell BR-C)
Lithium/polycarbonmonofluoride system [Li/(CF)n]
2. Nominal Voltage : 3 V
3. Nominal Capacity : 5000 mAh
4. Standard Discharge Current : 150 mA
5. Maximum Continuous Discharge Current : 300 mA
6. Overall Dimension : As per attached drawing
7. Weight : Approx. 42 g
8. Initial Characteristics
- 8.1 Open-circuit voltage : 3.0 V MIN.
- 8.2 Duration : 14 h MIN. ($20 \pm 2^\circ\text{C}$)
(Load resistance : 8Ω)
(End voltage : 1.8 V)
- 8.3 Impedance : 1Ω MAX. ($20 \pm 2^\circ\text{C}$)
Measuring Method : Sine wave A.C. method
Constant current : 0.1 mA
Frequency : 1 kHz
- 8.4 Temperature Range : Discharge -40°C to 85°C
Storage -20°C to 45°C

L I T H I U M B A T T E R Y

Precautions for use

- 1) A battery shall not be stored at temperatures in excess of 45°C. Storage at less than 30°C is recommended. Storage at less than -20°C can deform the plastic parts and may cause a leakage. To prevent self-discharge caused by corrosion, or decrease of insulation, humidity during storage shall be less than 70%.
- 2) The battery has an explosion resistant construction. But the following cautions should be taken, because combustible materials such as lithium metal and organic electrolyte are contained in the battery.
 - * Do not short circuit.
 - * Do not dispose in fire.
 - * Do not charge.
 - * Do not disassemble.
 - * Do not connect the wrong polarity (+, -)
- 3) Keep away from heat source or flame.
- 4) The battery shall not be washed by ultrasonic wave washer.

Symbol	Date	Revision	Signed	Checked

Marking

Panasonic
Lithium
BATTERY
BR-C
3V

充電禁止 DO NOT RECHARGE
MATSUSHITA ELECTRIC



警告
●充電・ショート・分解・変形・加熱・火中投入禁止。発熱・膨脹・発火の危険に注意。
⚠

⚠WARNING: FIRE, EXPLOSION, LEAKAGE, AND SEVERE BURN HAZARD. DO NOT RECHARGE, DISASSEMBLE, HEAT ABOVE 212°F, INCINERATE, OR EXPOSE CONTENTS TO WATER. BE SURE THE BATTERY IS INSERTED IN RIGHT DIRECTION. MADE IN JAPAN

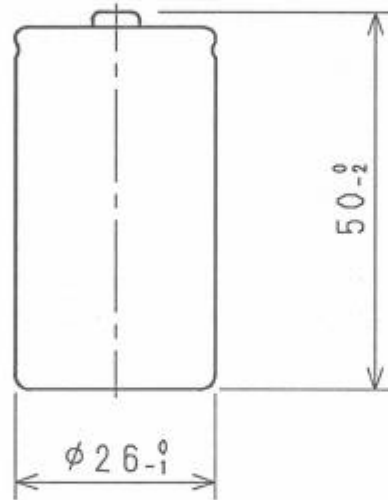
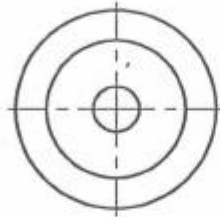

unit : mm

Symbol	Material & Size	Process	Remark
LITHIUM BATTERY BR-C			
Scale 1:1	Designed	Reviewed S.N	Model No. BR-CSP
		Checked m.E	Name Product Drawing
		Checked [Signature]	No. 97070114
		Approved [Signature]	