



LR14 Power Alkaline Max

Product specifications for cylindrical alkaline battery

A handwritten signature in black ink, enclosed within a rectangular box.

Approved by

LR14 Power Alkaline Max

1

1. Battery Identification

Name	LR14/ AM2/ C/ MN1400
Type	alkaline/ foil
Nominal Voltage	1.5 V
Electrolyte	KOH (potassium hydroxide)
Average Weight	68.3 g
Manufactured by	PMBC

2. Battery Dimensions

Dimension	Max	Min	Typical
A	50.0		49.6
B		48.6	49.3
C		13.0	17.4
E	0.9		0.3
F	7.5		6.3
G		1.5	2.2
Ø	26.2	24.9	25.4

Unit : mm

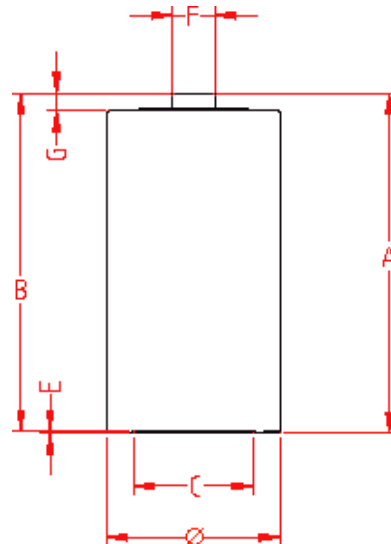

3. Battery Performance

A. Typical Discharge Values

TEST	RESISTANCE	DAILY PERIOD	END POINT	RESULT
Radio	20 ohm	4h	0.9 V	117 h
Recorder	6.8 ohm	1h	0.9 V	34 h
Motor	3.9 ohm	1h	0.8 V	21 h
LIF	3.9ohm 4'/1h	8h	0.9 V	1165 min
Continuous	2.2 ohm	24h	0.8 V	560 min
Continuous	3.9 ohm	24h	0.8 V	1200 min

4. Discharge Curves

Following charts show the results in IEC discharge modes.

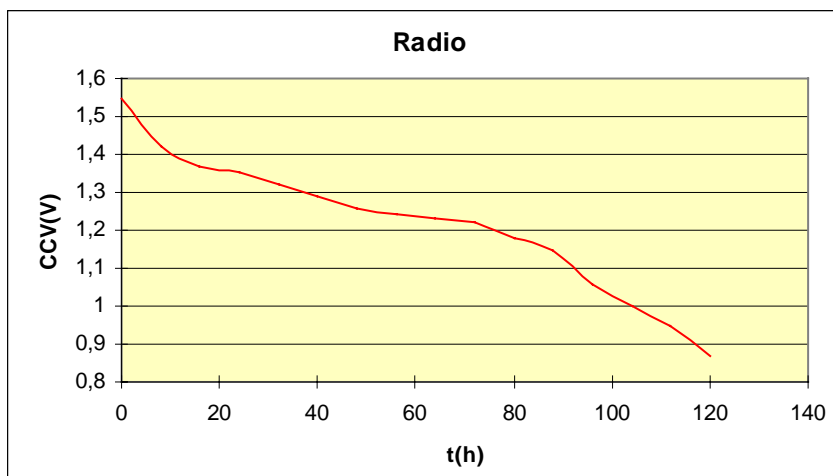
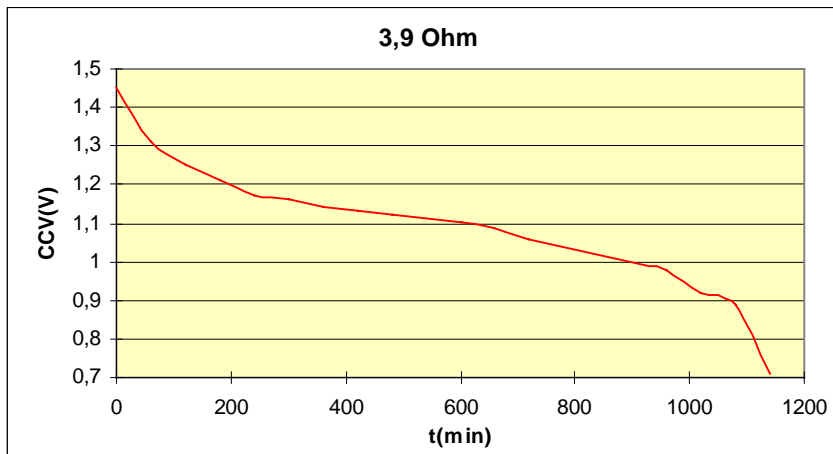
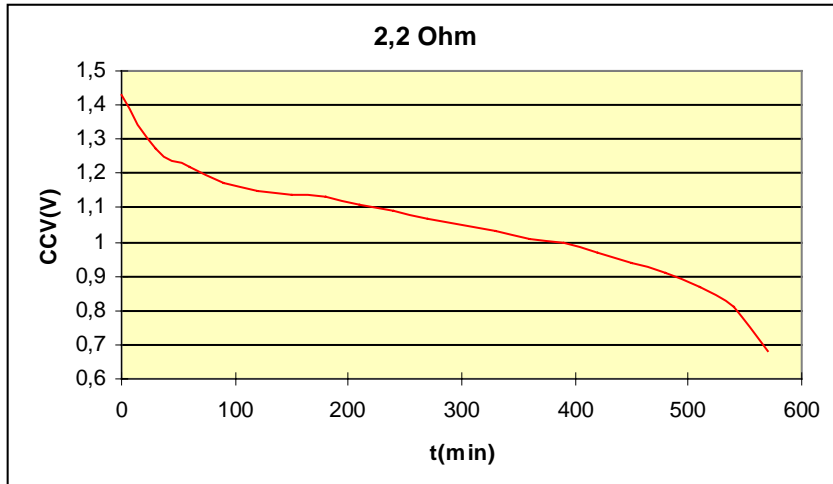

LR14 Power Alkaline Max

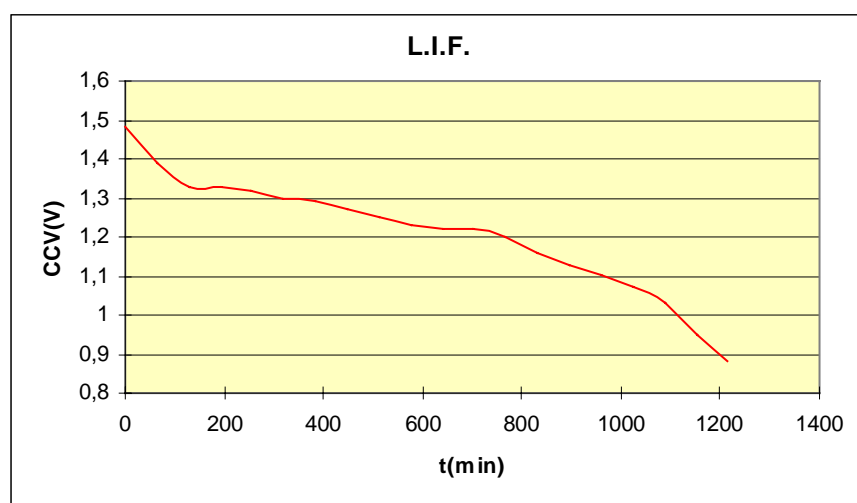
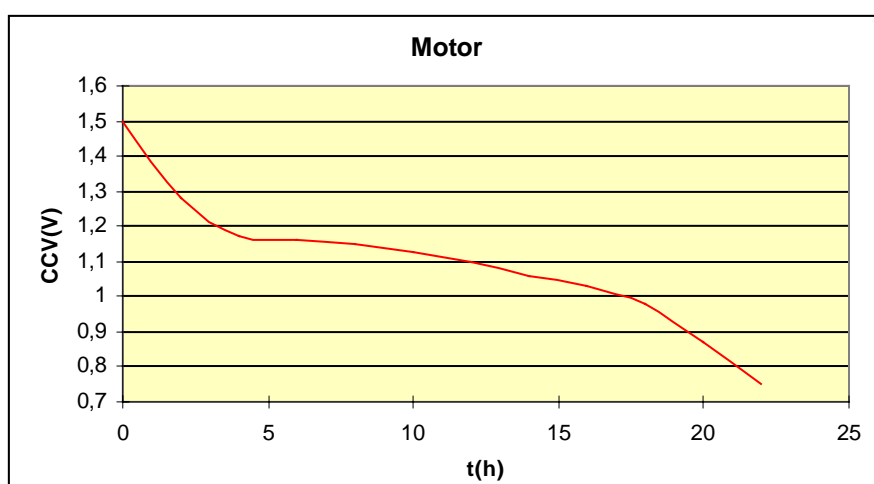
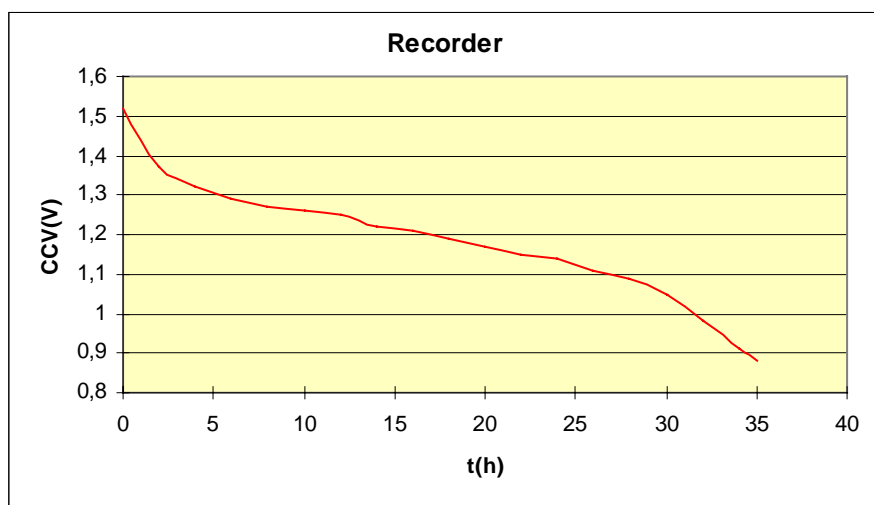

LR14 Power Alkaline Max

4

5. Material Safety Data Sheet

Item	Material	%
Total Weight		68,3 g
Cathode	MnO/C	45%
Anode	Zn/KOH	26%
Separator	Paper	1%
Current Collector	Brass	2%
Electrolyte	KOH/H ₂ O	8%
Steel Can	Ni plated steel	14%
Bottomplate	Ni plated steel	3%
Label	PVC, Al	1%

No Mercury (Hg), Cadmium (Cd) or Lead (Pb) are used in the battery.