

Technical specifications

Alkaline

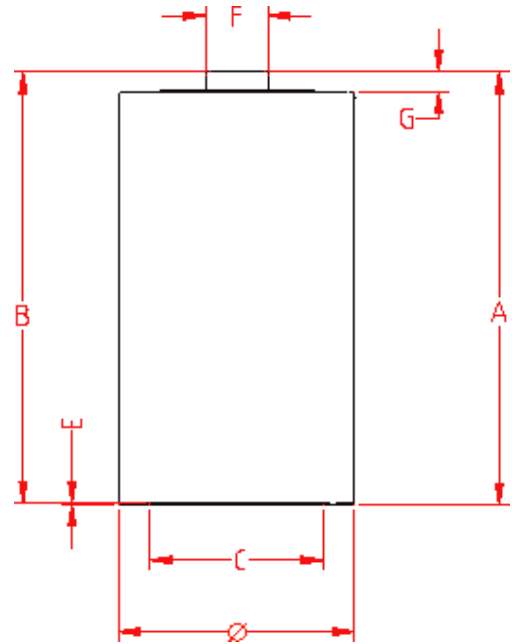

LR20AD



IEC dimensions			Panasonic
Dimension	max.mm.	min.mm.	Typical (+/-)
A	61,5		60,6
B		59,5	60,1
C		18,0	24,2
E	1,0		0,5
F	9,5		9,0
G		1,5	2,5
Ø	34,2	32,3	33,0

Name	LR20 / XL / D / AM1 / MONO / MN1300 / 13A / 13AC
Made in	Belgium
Type	Alkaline Foil
Nominal voltage	1,5 Volt
Electrolyte	Potassium Hydroxide
Average weight	142,7 g
Storage temp.range	+10°C ~ +25°C
Operating temp.range	-20°C ~ +45°C
Average impedance	+/- 90 m-Ohm @ 1kHz fresh
Heavy metals	No added mercury (Hg), Cadmium (Cd) or Lead (Pb)
Compliant to	IEC 60086
	non dangerous goods regulation
	Nordic ecolabeling (white Swan)
	EC directive 91/157EC & 98/101EC
Recommended cut off voltage	0,8V per cell

For more information:

www.panasonic-batteries.com

Panasonic
ideas for life

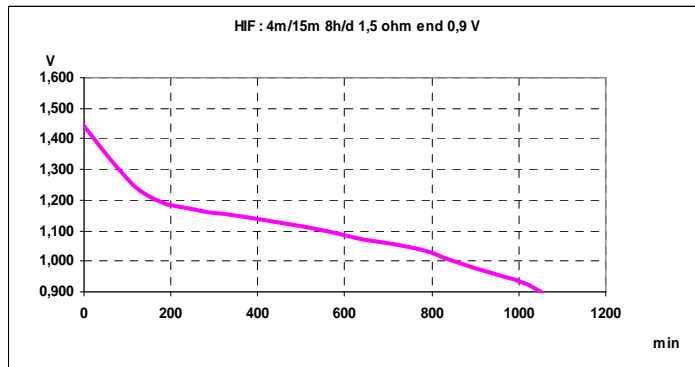
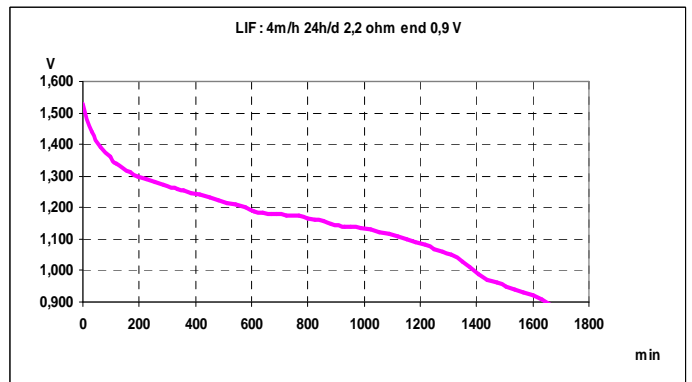
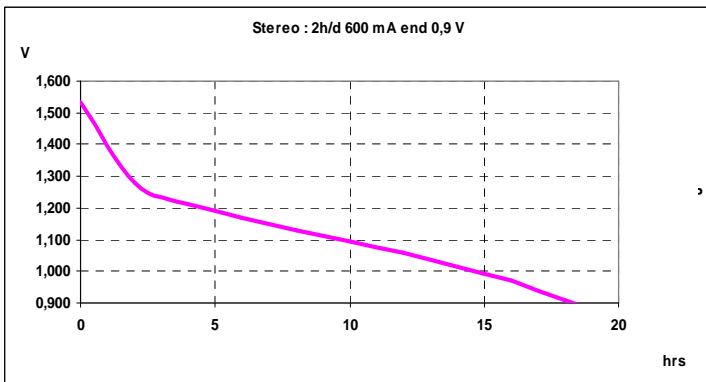
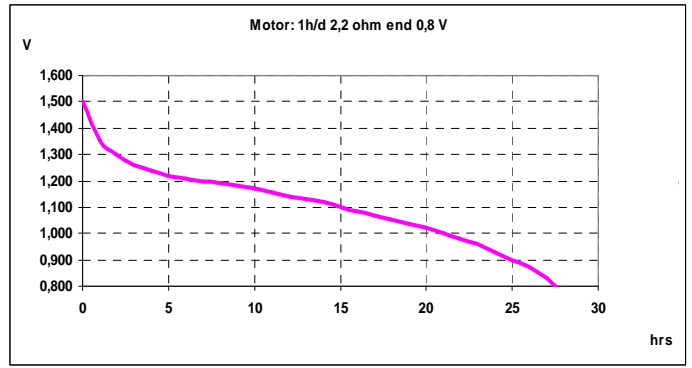
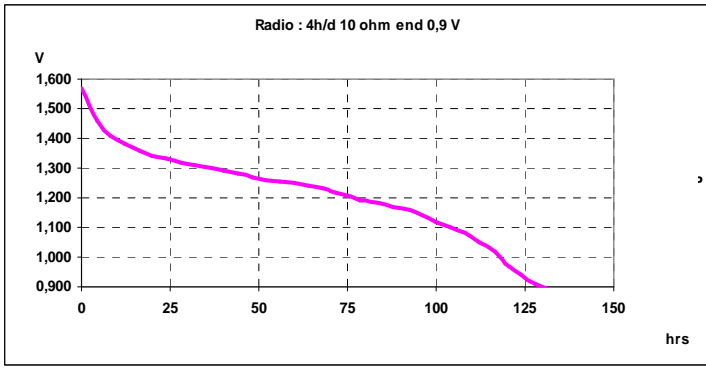

Copyright© Panasonic Battery Sales Europe ("PBSE") 2008 - All rights reserved. The information contained herein is believed to be correct. However no warranty is made, either expressed or implied regarding the accuracy or the results to be obtained from the use of such information. Test results are strictly according to IEC conditions. Capacities of batteries are depending on drain, temperature and cut-off voltage. Data are subject to change. 04/2008.

Promoter: Panasonic Battery Sales Europe N.V., J. Bogaerts, Brusselsesteenweg 502, 1731 Zellik, Belgium

For other local offices: www.panasonic-batteries.com

Technical specifications

Alkaline



LR14AD

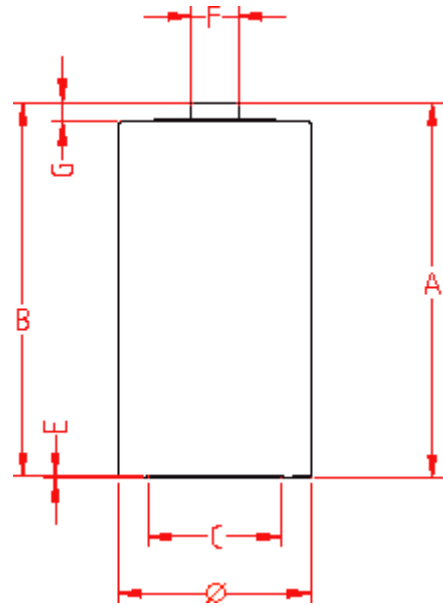

IEC dimensions			Panasonic
Dimension	max.mm.	min.mm.	Typical (+/-)
A	50,0		49,6
B		48,6	49,3
C		13,0	17,4
E	0,9		0,3
F	7,5		6,3
G		1,5	2,2
Ø	26,2	24,9	25,4

Name	LR14 / L / C / AM2 / BABY / MN1400 / 14A / 14AC
Made in	Belgium
Type	Alkaline Foil
Nominal voltage	1,5 Volt
Electrolyte	Potassium Hydroxide
Average weight	69,5 g
Storage temp.range	+10°C ~ +25°C
Operating temp.range	-20°C ~ +45°C
Average impedance	+/- 100 m-0hm @ 1kHz fresh
Heavy metals	No added mercury (Hg), Cadmium (Cd) or Lead (Pb)
Compliant to	IEC 60086 non dangerous goods regulation Nordic ecolabeling (white Swan) EC directive 91/157EC & 98/101EC
Recommended cut off voltage	0,8V per cell

For more information:

www.panasonic-batteries.com

Panasonic
ideas for life

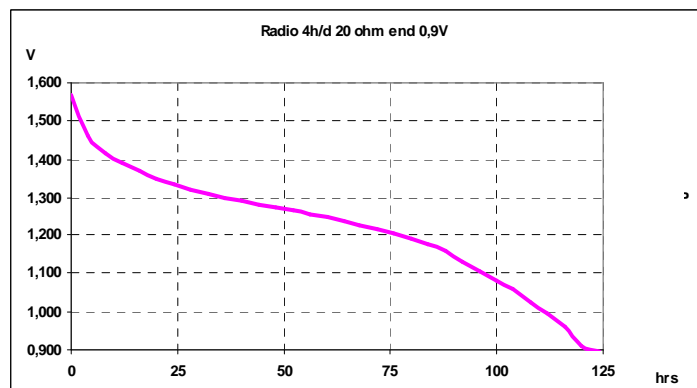
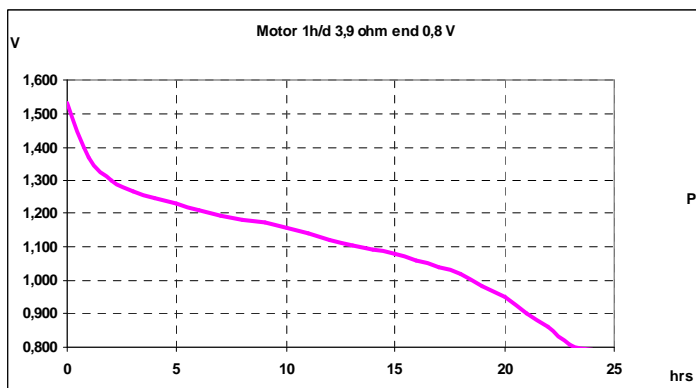
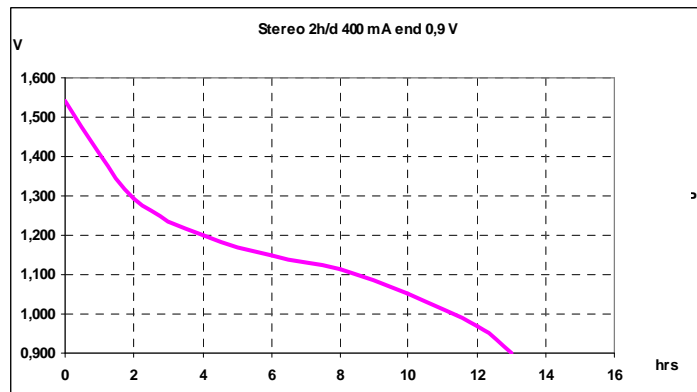
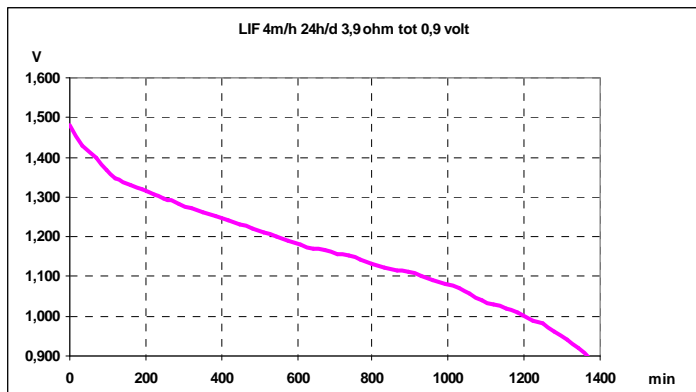

Copyright© Panasonic Battery Sales Europe ("PBSE") 2008 - All rights reserved. The information contained herein is believed to be correct. However no warranty is made, either expressed or implied regarding the accuracy or the results to be obtained from the use of such information. Test results are strictly according to IEC conditions. Capacities of batteries are depending on drain, temperature and cut-off voltage. Data are subject to change. 04/2008.

Promoter: Panasonic Battery Sales Europe N.V., J. Bogaerts, Brusselsesteenweg 502, 1731 Zellik, Belgium

For other local offices: www.panasonic-batteries.com

Technical specifications

Alkaline



LR6AD

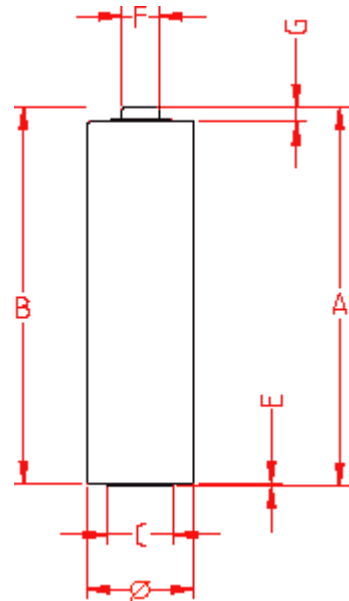

IEC dimensions			Panasonic
Dimension	max.mm.	min.mm.	Typical (+/-)
A	50,5		50,1
B		49,2	49,8
C		7,0	8,7
E	0,5		0,3
F	5,5		5,0
G		1,0	1,6
Ø	14,5	13,5	14,1

Name	LR6 / M / AA / AM3 / MIGNON / MN1500 / 15A / 15AC			
Made in	Belgium			
Type	Alkaline Foil			
Nominal voltage	1,5 Volt			
Electrolyte	Potassium Hydroxide			
Average weight	23,3 g			
Storage temp.range	+10°C ~ +25°C			
Operating temp.range	-20°C ~ +45°C			
Average impedance	+/- 105 m-0hm @ 1kHz fresh			
Heavy metals	No added mercury (Hg), Cadmium (Cd) or Lead (Pb)			
Compliant to	IEC 60086			
	non dangerous goods regulation			
	Nordic ecolabeling (white Swan)			
	EC directive 91/157EC & 98/101EC			
Recommended cut off voltage	0,8V per cell			

For more information:

www.panasonic-batteries.com

Panasonic
ideas for life

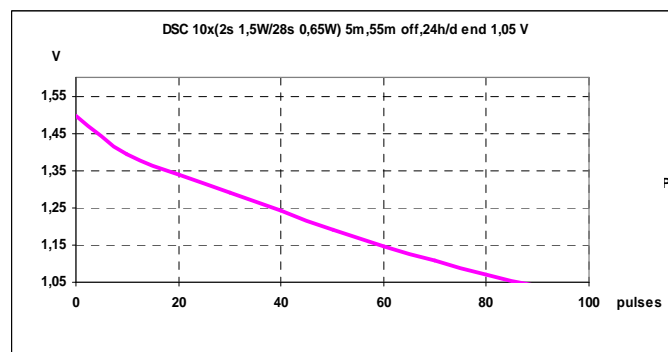
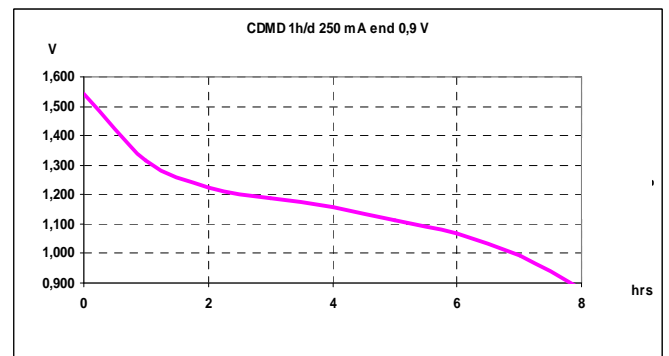
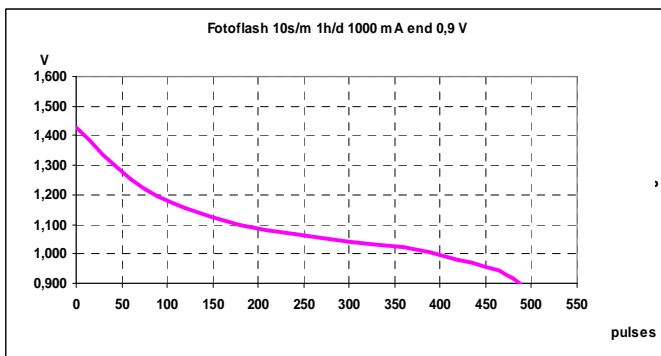
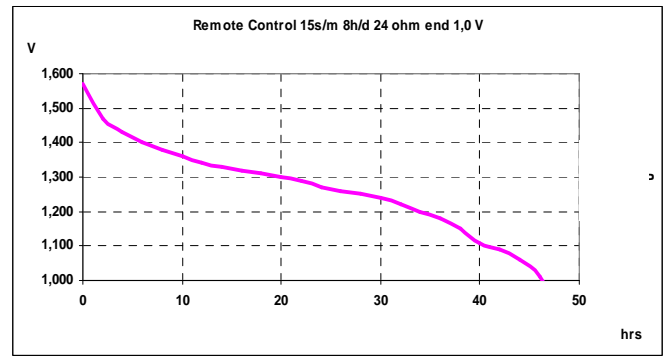
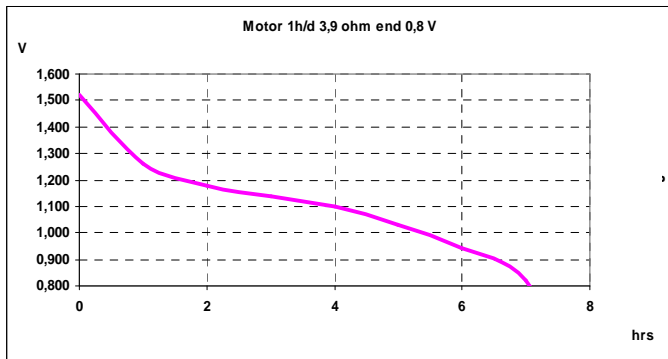
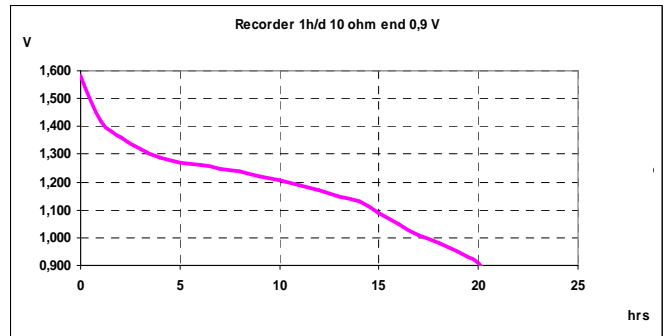
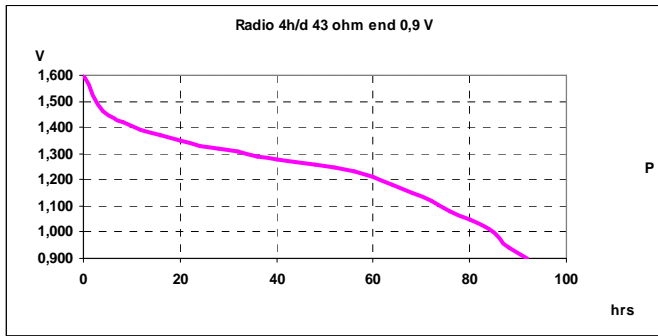

Copyright© Panasonic Battery Sales Europe ("PBSE") 2008 - All rights reserved. The information contained herein is believed to be correct. However no warranty is made, either expressed or implied regarding the accuracy or the results to be obtained from the use of such information. Test results are strictly according to IEC conditions. Capacities of batteries are depending on drain, temperature and cut-off voltage. Data are subject to change. 04/2008.

Promoter: Panasonic Battery Sales Europe N.V., J. Bogaerts, Brusselsesteenweg 502, 1731 Zellik, Belgium

For other local offices: www.panasonic-batteries.com

Technical specifications

Alkaline



LR03AD

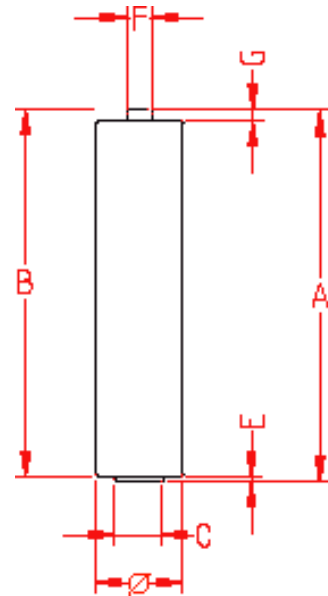

IEC dimensions			Panasonic
Dimension	max.mm.	min.mm.	Typical (+/-)
A	44,5		44,3
B		43,3	43,9
C		4,3	6,0
E	0,5		0,46
F	3,8		3,3
G		0,8	1,2
Ø	10,5	9,5	10,4

Name	LR03 / 5 / AAA / AM4 / MICRO / MN2400 / 24A / 24AC
Made in	Belgium
Type	Alkaline Foil
Nominal voltage	1,5 Volt
Electrolyte	Potassium Hydroxide
Average weight	11,2 g
Storage temp.range	+10°C ~ +25°C
Operating temp.range	-20°C ~ +45°C
Average impedance	+/- 135 m-0hm @ 1kHz fresh
Heavy metals	No added mercury (Hg), Cadmium (Cd) or Lead (Pb)
Compliant to	IEC 60086 non dangerous goods regulation Nordic ecolabeling (white Swan) EC directive 91/157EC & 98/101EC
Recommended cut off voltage	0,8V per cell

For more information:

www.panasonic-batteries.com

Panasonic
ideas for life

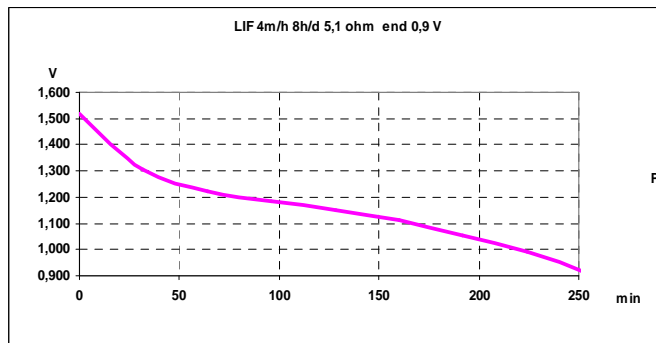
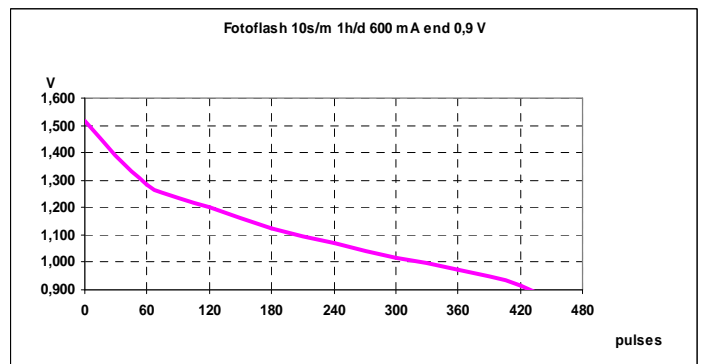
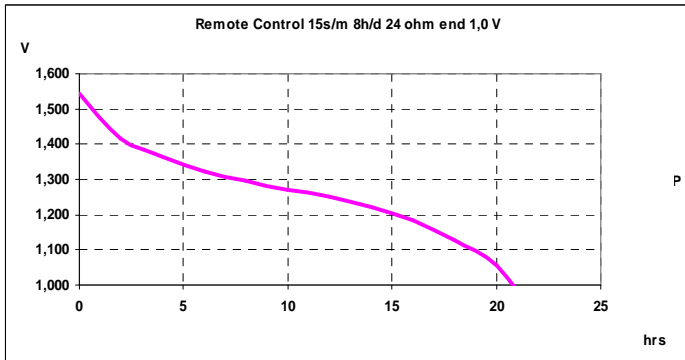
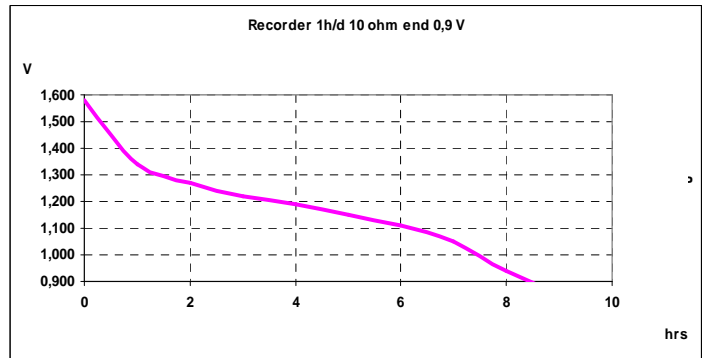
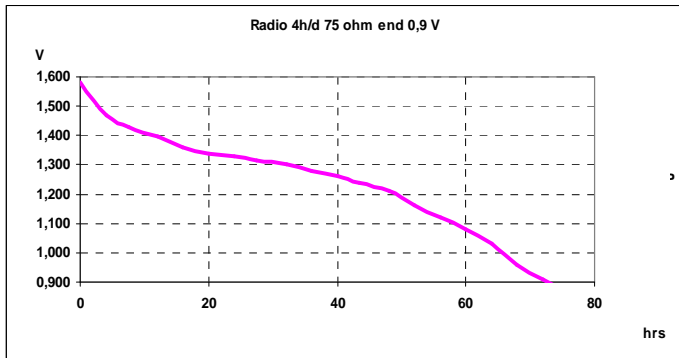

Copyright© Panasonic Battery Sales Europe ("PBSE") 2008 - All rights reserved. The information contained herein is believed to be correct. However no warranty is made, either expressed or implied regarding the accuracy or the results to be obtained from the use of such information. Test results are strictly according to IEC conditions. Capacities of batteries are depending on drain, temperature and cut-off voltage. Data are subject to change. 04/2008.

Promoter: Panasonic Battery Sales Europe N.V., J. Bogaerts, Brusselsesteenweg 502, 1731 Zellik, Belgium

For other local offices: www.panasonic-batteries.com

Technical specifications

Alkaline



6LR6AD

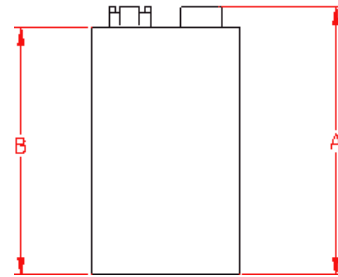
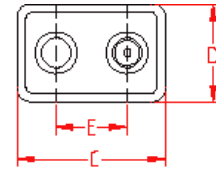

IEC dimensions			Panasonic
Dimension	max.mm.	min.mm.	Typical (+/-)
A	48,5	46,5	48,0
B	46,4		44,2
C	26,5	24,5	25,6
D	17,5	15,5	16,5
E	12,95	12,45	12,7

Name	9V / 6LR61 / 6AM6 / MN1604 / 1604A / 1604AC		
Made in	Belgium		
Type	Alkaline Foil		
Nominal voltage	9 Volt		
Electrolyte	Potassium Hydroxide		
Average weight	44,3 g		
Storage temp.range	+10°C ~ +25°C		
Operating temp.range	-20°C ~ +45°C		
Average impedance	+/- 2,3 Ohm @ 1kHz fresh		
Heavy metals	No added mercury (Hg), Cadmium (Cd) or Lead (Pb)		
Compliant to	IEC 60086		
	non dangerous goods regulation		
	Nordic ecolabeling (white Swan)		
	EC directive 91/157EC & 98/101EC		
Recommended cut off voltage	4,8V per battery		

For more information:

www.panasonic-batteries.com

Panasonic
ideas for life

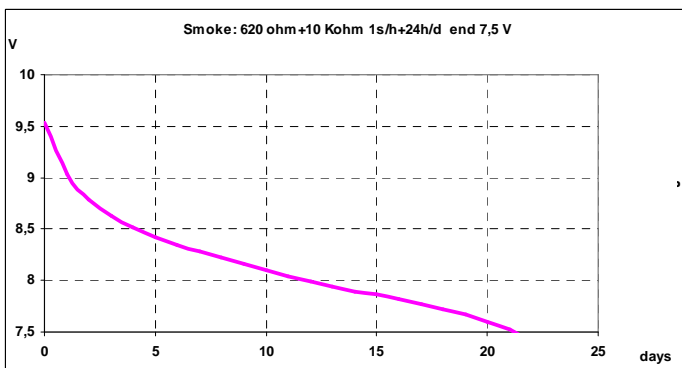
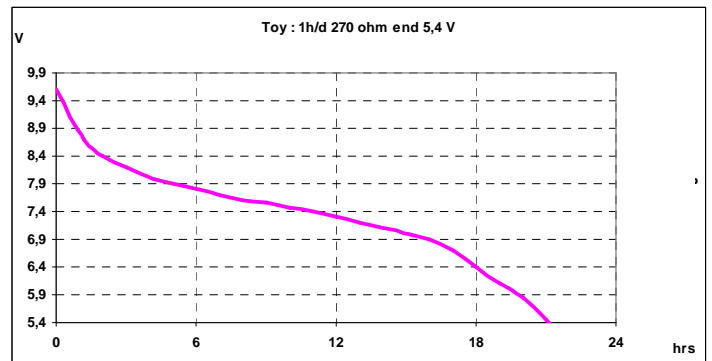
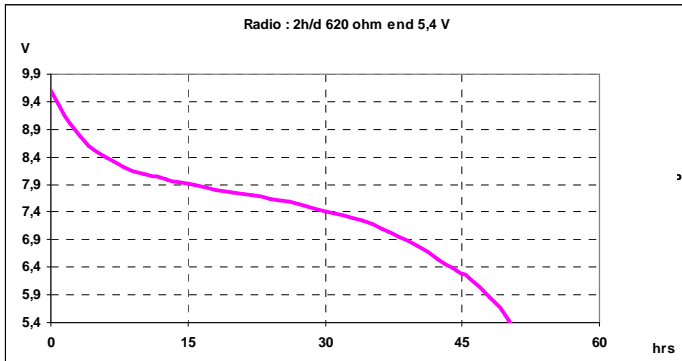

Copyright© Panasonic Battery Sales Europe ("PBSE") 2008 - All rights reserved. The information contained herein is believed to be correct. However no warranty is made, either expressed or implied regarding the accuracy or the results to be obtained from the use of such information. Test results are strictly according to IEC conditions. Capacities of batteries are depending on drain, temperature and cut-off voltage. Data are subject to change. 04/2008.

Promoter: Panasonic Battery Sales Europe N.V., J. Bogaerts, Brusselsesteenweg 502, 1731 Zellik, Belgium

For other local offices: www.panasonic-batteries.com